

THE DOCUMENTATION OF THE CRAIG CEMETERY
By Bob Shelton and Clovis Linkous, 1999
Updated and Expanded by Sherry Joines Wyatt, 2011

The Craig Cemetery was once part of the large Hans Meadow estate owned by James Craig and his wife, Anne Montgomery Craig. James Craig was involved in the early establishment of Montgomery County (1776) and the Town of Christiansburg (1792). The first court session in what would become Christiansburg was held at Craig's home or ordinary on May 4, 1790.

The earliest known burial in the cemetery date to 1806 and roughly a dozen families are represented. The cemetery was first formally set aside in the will of Mary T. Craig. It is one acre in area which if fully utilized by ordinary spacing of graves and walk ways would accommodate 640 graves, but physical evidence from the cemetery indicates that it is only about 24% utilized. Bob Shelton and Clovis Linkous identified 166 grave sites in 1999. The cemetery has been little used since about 1950. The last internment was in 1985; cremains were scattered in 2011. The family care that probably was once excellent has long since ceased. When the Montgomery Museum accepted the maintenance responsibility, the condition of the cemetery was physically deplorable and no records of who is buried where were found. Furthermore, we know of no agreement revealing family or individual eligibility for being buried in this cemetery.

Many of the graves in the cemetery never had a stone marker and the other graves have had their stones broken, fallen over or moved from a combination of weathering, vandalism and misguided efforts to clean up the cemetery. The grave sites only evidenced by a depression in the earth as well as graves with stones were documented in 1999 by Bob Shelton and Clovis Linkous, then Board Members of the Montgomery Museum. This was done with the approval of the Board as a base record of the whole cemetery showing the location of each identifiable grave using the fence lines as reference points. All headstones are on the west end of the grave and the graves lie in the east-west direction. There are 20 rough rows of graves running in the north-south direction. These "rows" are not parallel with the western fence, but rather the north end of a row is somewhat closer to the northwest corner than the south end is from the southwest corner. Also, numerous graves are clearly out of alignment with others that seem to define a row. There are no clearly evident walk ways or lots in the Craig Cemetery.

The borders of the cemetery are defined by a formal Survey incorporated in the Deed of Gift dated May 11, 1990, a copy of which is on the following page. (Please note that the 1993 Right of Way shown on this survey was altered in a Deed of Easement dated April 30, 1993).

The Montgomery Museum and Lewis Miller Regional Art Center accepted ownership of the Craig Cemetery as a gift in a deed executed on May 11, 1990. Also, as permitted by a Decree of the Circuit Court on May 29, 1991, the Museum accepted a fund from a Trust established by Mary Sherwood Flagg to be used for the rendering immediate care and future maintenance of the cemetery.

REFERENCES: L-3029 (Crosier); L-1584 (Triangle Equip. Co.); Map of Shiloh Hgts #3 (Not of Record)

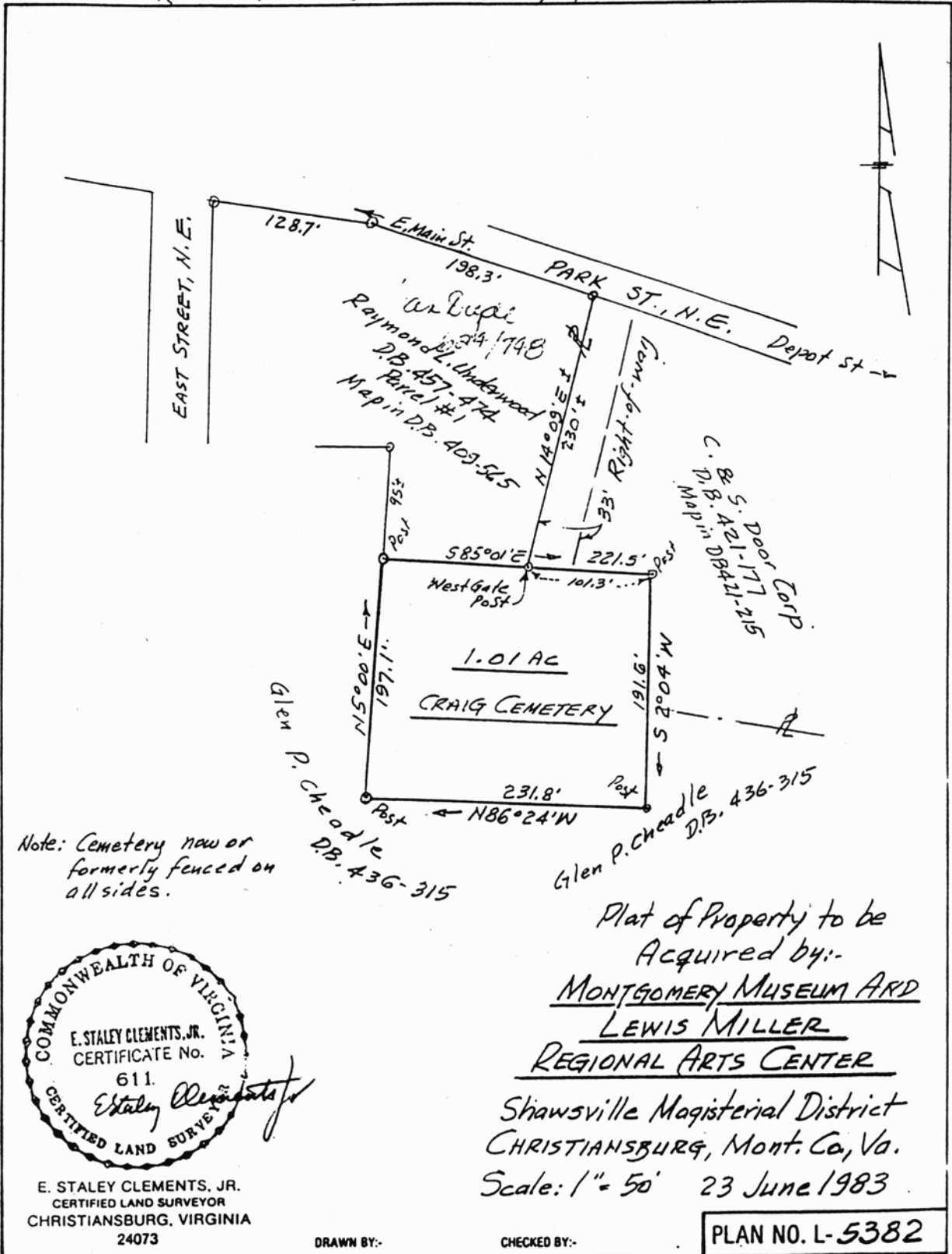

Note: Cemetery now or formerly fenced on all sides.

Plat of Property to be Acquired by:-
MONTGOMERY MUSEUM AND
LEWIS MILLER
REGIONAL ARTS CENTER

Shawsville Magisterial District
 CHRISTIANSBURG, Mont. Co., Va.
 Scale: 1" = 50' 23 June 1983

PLAN NO. L-5382

BRUNING 58100

DRAWN BY:-

CHECKED BY:-

INFORMATION CONCERNING THE DEED TO THE CRAIG CEMETERY
OF CHRISTIANSBURG, VIRGINIA
Compiled by Clovis Linkous, 2000

1. The land was originally a part of a large tract belonging to the Craig family pre-dating the establishment of Christiansburg. The Cemetery is a few hundred yards west of the Craig family home known as Hans Meadow. The earliest known burial is 1806.
2. Deed Book V, page 388, Oct. 16, 1879:
Mary T. Craig receives a deed to 170 acres from a division of land within the Craig family. Her share encompassed the cemetery as recorded in Deed Book 84, page 257.
3. Deed Book 84, page 257, Jan. 25, 1926:
Mary T. Craig sells 44 1/4 acres on the north side of the Lee Highway to James S. Childress and Floyd S. Childress. The deed specifically states "The Craig Cemetery containing one acre is reserved and excepted from the provisions of this deed."
4. Deed Book 98, page 133, July 1934:
James S. Childress and Floyd S. Childress sell at a court ordered auction 44 1/4 acres to W. H. Calhoun specifically stating: "There is excepted from this conveyance the Craig Cemetery with a 33 foot right of way of ingress and egress from the old Turnpike Road and embraced in said survey as reserved in the said Childress deed. A deed was given by Julius Goodman, Commissioner for the Court on July 30, 1934.
5. Deed Book 98, page 262, Aug. 1, 1934:
J. C. Snidow, Sr. acquires this land from W. H. Calhoun.
6. During or near the year 1961, J. C. Snidow, Sr. dies and leaves a will.
7. Deed Book 231, page 363, Nov. 8, 1961:
J. C. Snidow, Jr. purchases 5 tracts of land from Julius Goodman acting as Commissioner for the Court, the proceeds to go to the beneficiaries of the Will of J. C. Snidow, Sr. Tract No. 1 is the land J. C. Snidow, Sr. purchased from W. H. Calhoun "after deducting therefrom conveyances heretofore made by the said J. C. Snidow, Sr." The remainder bordered on two sides of the Craig Cemetery according to the deed.
8. Deed Book 231, page 366, Nov. 17, 1961:
J. C. Snidow, Jr. mortgages 6 tracts of land to W. R. L. Craft, Jr. and C. R. Cheatham, Trustees for the Bank of Christiansburg. A statement from the Deed for Tract No.1 is as follows: "thence with the Wimmer and Altizer land S 5 degrees W 95.6 feet to a stake a corner to the Craig Cemetery; thence with the line of the Craig Cemetery and the Wimmer and Altizer land S 85 degrees 10 minutes E 221.5 feet to a post a corner to the Craig Cemetery S 2 degrees West 108 feet to a point in the Craig Cemetery line; thence -----." The whole survey being the balance and remainder of the 8/1/1934 purchase by J. C. Snidow, Sr.
9. Deed Book 436, page 315, Oct. 23, 1980:
J. C. Snidow, Jr. and wife sell to Glenn P. Cheadle and wife land on the south side of Park Street and bordering the Craig Cemetery, the land to be used as a trailer park. The land being in part, a part of the land acquired by J. C. Snidow, Jr. on Nov. 8, 1961 recorded in Deed Book 231, page 363. The survey description reads in part: "----- S 5 degrees W 95.6 feet to a post, a corner to Craig Cemetery; thence with said Craig Cemetery S 85 degrees 10 minutes E 221.5 feet to a post, another corner to said cemetery; thence S 2 degrees 04 minutes W with said cemetery lot 108.0 feet to a post; thence leaving said cemetery -----."
10. Deed Book 582, page 582, Aug. 13, 1987:
In a Deed conveying lands from Glenn P. Cheadle to J. C. Snidow, Jr. there is the following statement:

"There was included within the metes and bounds boundary description of the lands acquired by the grantees herein from the grantors herein by said deed dated Oct. 23, 1980 a cemetery known as the Craig Cemetery. The parties of the second part [Cheadle] hereby quitclaim unto the parties of the first part [Snidow] all of their right, title and interest, if any, in and to said cemetery acquired by said deed."

11. Deed Book 688, page 465, May 11, 1990:

J. C. Snidow, Jr. and wife convey by a Deed of Gift to the Montgomery Museum and Lewis Miller Regional Art Center the cemetery known as "The Craig Family Cemetery" it being "all of the property acquired by J. C. Snidow, Jr., and Marguerite T. Snidow by deed dated 13 August 1987 from Glenn P. Cheadle and Natalie H. Cheadle of record in the Office of the Clerk of the Circuit Court of Montgomery County, Virginia, in Deed Book 582, Page 582." The deed includes an exact survey of the whole cemetery.

Alphabetical List of Known Interred Persons

Bob Shelton and Clovis Linkous identified 166 graves in their 1999 inventory. This inventory also made use of a partial inventory of 69 names, made c.1950 by Marvin U. Neighbors, that was included in Lula Porterfield Givens' book, *Christiansburg Montgomery County Virginia, In the Heart of the Alleghenies*. There are 50 unknown burials. Not included by Shelton and Linkous is information found in a partial list of burials in Anne Lowell Worrell's 1934 book *Over the Mountain Men*. It should be noted that many of the headstones are worn and difficult to read. There may be reading errors. In some cases, the reading of names and dates by the Givens source or Worrell differed from that of Shelton and Linkous. In these cases the Shelton and Linkous reading is presented.

In the following tables the source of the information is as follows:

S-L: 1999 Survey Bob Shelton and Clovis Linkous

MN: c.1950 Survey by Marvin U. Neighbors; the location of headstones is not part of this list

ALW: 1934 Survey by Anne Lowell Worrell in her book *Over the Mountain Men*; the location of headstones is not part of this list.

ALPHABETICAL LIST OF KNOWN BURIALS

NAME	Location	Source	AVAILABLE INFORMATION
Akers, Millard Filmore	Row # 6	S-L	b. Oct. 16, 1848; d. Feb 25, 1931
Akers, Sarah Elizabeth	Row # 6	S-L	b. Nov 23, 1851; d. April 2, 1904
Alley, Anderson	Row # 6	S-L MN	b. June 11, 1817; d. Aug. 14, 1890
Alley, Martha	Row # 6	S-L MN	June 17, 1822; d. May 28, 1872; Wife of Anderson Alley
Anderson, George, Dr.	Scattered Fragment	S-L MN ALW	b. Apr. 19, 1779; d. Sept 22, 1818; This slab inscribed to his memory by his widow who deeply deplores his loss.
Anderson, John	Scattered Fragment	S-L MN ALW	b. Apr. 19, 1789; d. Mar. 16, 1821; This Tribute of ---- Affection was erected to his memory by son George.
Anderson, Sarah Leek	Missing in 1999	MN ALW	d. Mar. 4, 1833; Age 3 years, 8 month and 20 days.
Beasley, Kate Lester Craig	Row # 18	S-L	(1901-1985)
Blankenship, Isaac	Row # 5	S-L	(1860-1887)
Bratton, James, Capt.	Scattered Fragment	S-L MN ALW	Who died in Christiansburg Jan. 2, 1814 and infant daughter Elizabeth M. Bratton who died July 25, 1806 Aged 9 months.
Bratton, Elizabeth M.	Missing in 1999	MN ALW	d. July 25. 1806; Age 9 months.
Brown, James	Row # 9	S-L MN	Of Madison, Miss; Died July 3, 1866; Age 60 years. No stone.

		ALW	
Clark, Charles B.	Row # 3	S-L	b. Sept. 7, 1864, d. Oct. 22, 1941.
Clark, James R.	Row # 4	S-L MN ALW	(1827-1903)
Clark, Lila D.	Row # 3	S-L	(1874-1937)
Clark, Mary Ann	Row # 4	S-L MN	(1841-1916)
Clark, Mary L.	Row # 4	S-L	(1872-1914)
Clark, Nannie C.	Row # 3	S-L	Wife of C. B. Clark. b. Mar. 4, 1847, d. Aug. 20, 1922.
Clark, Robert E.	Row # 4	S-L	(1867-1932)
Clark, William L.	Row # 4	S-L	(1876-1898)
Craig, Anna Montgomery	Missing in 1999	MN ALW	d. Dec. 2, 1841; Age 74 years; Wife of Captain James Craig.
Craig, Annie Augusta	Row # 20	S-L MN	b. Feb. 12, 1886; d. Mar. I, 1953.
Craig, Brainard W.	Row # 20	S-L MN	Pvt. 34 AAF Pursuit Sq. World War 1; b. Aug. 12, 1893; d. Apr. 7, 1950
Craig, Charles Joseph	Row # 20	S-L MN	Apr. 17, 1844 – Feb. 28, 1923
Craig, Charles Lewis	Row # 19	S-L MN	b. Apr. 17, 1844; d. Feb. 28, 1923.
Craig, Elizabeth Gray	Row # 20	S-L MN	b. Feb. 1898; d. Oct. 16, 1898.
Craig, Emeline	Row # 13	S-L MN ALW	b. Nov. 1, 1813; d. Jan. 3, 1892; Wife of John Craig.
Craig, James, Capt.	Row # 14	S-L MN ALW	d. Feb. 8, 1834; Age 72 Years
Craig, James R.	Row # 13	S-L	(1850-1875)
Craig, John	Row # 13	S-L MN ALW	b. Apr. 25. 1794; d. Aug. 27, 1852.
Craig, John B .	Row # 20	S-L	(1892-1968)
Craig, John, Jr.	Row # 13	S-L MN ALW	b. Jan. 14, 1839; d. May 3, 1863; Fell in Battle of Chancellorsville.

Craig, Mary T.	Row # 12	S-L MN	b. Oct. 21, 1841; d. Jan. 16, 1929.
Douglas, Charity	Row # 13	S-L ALW	Consort of Ben T. Douglas; d. 1833; 90 years.
Dudley, Maggie L.	Row # 6	S-L	(1886-1912)
ECF (?)	Row # 5	S-L	Unreadable stone
Flagg, Ellen Craig	Row # 11	S-L	(1847-1892)
Flagg, Ellen Craig	Row # 14	S-L	Wife of W. Flagg; it is not clear if this is a second stone related to the person as above or a second person
Flagg, Henry E.	Row # 11	S-L	(1887-1887)
Flagg, Infant	Row # 11	S-L	(1882-1882)
Flagg, James R.	Row # 18	S-L MN	(1856-1929)
Flagg, James Robert	Row # 11	S-L	(1885-1889)
Flagg, Mary Sherwood	Row # 11	S-L	(1884-1973)
Flagg, Mrs. M. J.	Row # 18	S-L MN	b. Jan. 4, 1836; d. Jan. 30. 1910.
Flagg, Robert	Missing in 1999	MN	b. July 10, 1885; d. Jan 8, 1889.
Flagg, William C.	Row # 11	S-L MN	(1859-1925)
Flagg, William J.	Row # 11	S-L	(1889-1961)
Flagg Family Stone	Row # 11		
Franklin, M. B.	Row # 2	S-L	b. Oct. 29, 1844, d. Jan. 19, 1931.
Franklin, Minero Shufflebarger	Row # 2	S-L MN	b. May 17, 1833; d. Mar. 26, 1907: Wife of M. B. Franklin.
Gilmore, C .T.	Row # 4	S-L	(1875-1899)
Gilmore, C. E	Row # 4	S-L	(1856-1928)
Gilmore, Mrs. C. E	Row # 4	S-L	(1859-1927)
Gilmore, Parris J.	Row # 4	S-L	-1888
HNAN (?)	Row # 19	S-L	d. 1821; Stone in poor condition.
Haymaker, Martha	Row # 4	S-L MN ALW	Wife of Phillip Haymaker, Sr.; b. Jan 12, 1814; d. June 26, 1888.
Holman, Martha F.	Row # 8	S-L MN ALW	b. Feb. 22. 1819; d. Nov. 3, 1868; wife of Geo. P. Holman.

Jennings, B. F.	Row # 12	S-L MN	b. April 19, 1837; d. Aug. 5, 1914. A Confederate soldier, 1861-1865.
Jennings, Luther A.	Row # 12	S-L MN	b. Oct. 26, 1873; d. Aug. 18, 1918.
Jennings, Matilda H.	Row # 12	S-L MN	Died Oct. 12, 1907; Age 66 years.
Jones, Cephas	Row # 8	S-L	(1883-1898)
Jones, David	Row # 20	S-L MN	b. 1811; d. Jan. 2, 1891; Father.
Jones, Dow	Row # 8	S-L	(1848-1911), Age 63 years. No stone.
Jones, Margaret	Row # 20	S-L MN	b. 1831; d. Mar. 3, 1922; Mother.
Kyle, Amanda Montgomery	Row # 16	S-L MN	(1852-1895)
Kyle, Robert Gibboney	Row # 16	S-L MN	(1845-1864)
Kyle, Sallie Meade	Row # 16	S-L MN	(1822-1903)
Kyle, William Emmett	Row # 16	S-L MN	(1819-1875)
Lee, Mary J.	Missing in 1999	MN	b. Aug. 15, 1839; d. Apr. 27, 1889.
Rebecca A.	Missing in 1999	MN	b. Mar. 15, 1859; d. Mar. 14, 1879.
Martin, James M.	Row # 2	S-L	Stone partially buried. There may be dates underground.
Miller, Charles A., Rev.	Row # 13	S-L MN	b. Nov. 15, 1819, d. March 26, 1893. Father.
Miller, Joseph, Dr.	Row # 13	S-L MN ALW	b. Sep. 7, 1784; d. Jan. 17, 1849.
Miller, Mrs. Fannie	Row # 13	S-L MN	Widow of T. W. Micon; Wife of Charles A. Miller; b. May 13, 1819; d, May 26, 1860.
Miller, Lewis	Row # 13	S-L MN ALW	b. May 3, 1796; d. Sep. 15, 1882.
Miller, Matilda L.	Row # 13	S-L MN	b. Feb. 16, 1785; d. Feb 17, 1854. Aged 69 years 1 day
Miller, Melinda Taylor	Row # 13	S-L MN	b. Oct. 13, 1836, d. June 25, 1906. Mother.

Montgomery, Archie P.	Row # 3	S-L	(1912-1934)
Murray, Miss Jane	Row # 18	S-L MN	d. Oct. 29, 1884; Aged 84 years.
Murray, Miss Sallie	Row # 18	S-L	(1838-1928)
Murray, Mrs. Sarah	Row # 18	S-L MN	d. Oct. 4, 1879; Age 84.
Norvell, Frances C.	Row # 6	S-L ALW	(1813-1874) Mother
Parrish, Elizabeth K	Row # 2	S-L MN	b. 1849; d. 1926. Shared stone.
Parrish, Joel F.	Row # 2	S-L MN	b. 1847; d. 1921. Shared stone.
Pettus, Rebecca	Row # 16	S-L MN	b. July 15, 1881; d. Sep. 10, 1912
Pettus, Thomas W.	Row # 16	S-L	(1873-1897)
Reid, Miss Janet	Row # 15	S-L MN	Born in Coupar Angus, Perthshire, Scotland July 13, 1825; d. Nov. 13, 1900
Reid, Peter W.	Row # 15	S-L MN ALW	Born in Scotland June 9, 1830; d. near Christiansburg Jan. 30, 1909
Scott, Della	Row # 8	S-L	Broken stone.
Shelton, F. S.	Row # 5	S-L	(1891-1915)
Shelton, Willie C.	Row # 6	S-L	(1888-1890)
Shields, Bettie Eskridge	Row # 20	S-L	(1866-1879) Only child of H.W. and M. E. Shields
Shufflebarger, Magdalene	Missing in 1999	MN	b. Mar. 6, 1833; d. Nov. 18, 1895.
Shufflebarger, Maggie Sue	Row # 5	S-L	(1885-1888)
Shufflebarger, Malichi	Row # 5	S-L MN	b. Dec. 6, 1846; d. July 28, 1906.
Shufflebarger, Paris	Missing in 1999	MN	b. Oct. 29, 1826; d. Aug. 22, 1895. Aged 68 years, 9 mos., & 24 ds.
Spaulding, Hest_	Row # 2	S-L	(1784-1806) Fallen, broken stone.
Taylor, Eliz Scott	Row # 11	S-L MN	(1835-1911)
Taylor, Malinda Craig	Row # 11	S-L MN	b. July 25, 1836; d. July 5, 1911; Wife of John L. Taylor
Trigg, Robert C., Col.	Row # 8	S-L MN	Died Jan. 2, 1872; Broken stone.

		ALW	
Wade, Benjamin D.	Row # 17	S-L	d. 1833; 5 years old.
Wade, Mrs. Ella L.	Scattered Fragment	S-L MN	b. Apr. 11, 1842; d. Dec. 29, 1869; Wife of William Wade.
Wade, Eliza F.	Row # 19	S-L MN ALW	b. May, 1799; d. Oct. 30, 1839.
Wade, Emily	Row # 19	S-L MN	d. Jan. 14. 1873; Age 78 years.
Wade, George A.	Missing in 1999, 1950	ALW	Child of Hampton [sic] and Mary Wade; d. 1835
Wade, George E.	Row # 17	S-L	d. 1833.
Wade, Mary E.	Row # 17	S-L	d. 1833.
Wade, Mary	Missing in 1999, 1950	ALW	Child of Hampton [sic] and Mary Wade; d. 1833
Wade, Hamilton	Row # 18	S-L ALW	b. May 28, 1789; d. May 2, 1846.
Wade, Hamilton D.	Row # 17	S-L	d. 1833; 7 years old.
Wade, James	Row # 19	S-L MN ALW	b. Dec. 5, 1794; d. Apr. 27, 1839.
Wade, Rebecca	Row # 19	S-L MN ALW	b. June 1761; d. June 4, 1822; Widow of David Wade.
Wade, William	Row # 19	S-L MN	d. Apr. 11, 1857; Age 59 years.
Watson, Addell	Row # 13	S-L	b. May 22, 1843, d. Oct. 21, 1853. Daughter of Leonard C. and Mary Watson. b. at Gill, Mass. d. at Christiansburg.
Wills, Mattie	Row # 8	S-L	(1880-1908)
Woods, Malinda H.	Row # 5	S-L MN	b. Sept. 4, 1840; d. Dec. 22, 1922; Shared stone.
Woods, John G.	Row # 5	S-L MN	b. Apr 19, 1830; d. Oct. 3, 1895; Shared Stone.
Unknown	Row # 1	S-L	No stone.
Unknown	Row # 1	S-L	No stone.
Unknown	Row # 1	S-L	No stone.
Unknown	Row # 1	S-L	No stone.

Unknown	Row # 2	S-L	No stone.
Unknown	Row # 2	S-L	No stone.
Unknown	Row # 2	S-L	No stone.
Unknown	Row # 5	S-L	Unreadable stone
Unknown	Row # 5	S-L	Unreadable stone. Perhaps some letters are "LAK"
Unknown	Row # 5	S-L	No stone.
Unknown	Row # 5	S-L	No stone.
Unknown	Row # 5	S-L	No stone.
Unknown	Row # 5	S-L	No stone.
Unknown	Row # 5	S-L	No stone.
Unknown	Row # 5	S-L	No stone.
Unknown	Row # 6	S-L	No stone.
Unknown	Row # 6	S-L	No stone.
Unknown	Row # 6	S-L	Illegible child's stone.
Unknown	Row # 6	S-L	No stone.
Unknown	Row # 6	S-L	No stone.
Unknown	Row # 6	S-L	No stone.
Unknown	Row # 7	S-L	No stone.
Unknown	Row # 7	S-L	No stone.
Unknown	Row # 7	S-L	No stone.
Unknown	Row # 7	S-L	No stone.
Unknown	Row # 8	S-L	No stone.
Unknown	Row # 8	S-L	Broken stone.
Unknown	Row # 8	S-L	No stone.
Unknown	Row # 8	S-L	No stone.
Unknown	Row # 9	S-L	No stone.
Unknown	Row # 9	S-L	No stone.
Unknown	Row # 9	S-L	No stone.
Unknown	Row # 9	S-L	No stone.
Unknown	Row # 10	S-L	No stone.
Unknown	Row # 10	S-L	No stone.
Unknown	Row # 10	S-L	There may have been a stone at this location in times past.

Unknown	Row # 13	S-L	No stone.
Unknown	Row # 17	S-L	Stone has been moved. Probably a Wade.
Unknown	Row # 18	S-L	No stone.
Unknown	Row # 18	S-L	No stone.
Unknown	Row # 18	S-L	No stone.
Unknown	Row # 18	S-L	No stone.
Unknown	Row # 18	S-L	No stone.
Unknown	Row # 20	S-L	No stone.
Unknown	Row # 20	S-L	No stone.
Unknown	Row # 20	S-L	No stone.
Unknown	Row # 20	S-L	No stone.

1999 GRAVE SITE INVENTORY

ROW	NAME	Feet from South Fence¹	Feet from West Fence
ROW #1			
	Unknown	35.8	5.7
	Unknown	51.6	5.5
	Unknown	58.7	5.5
	Unknown	75.8	4.4
ROW #2			
	Hest_ Spaulding	10.2	14.7
	Unknown	23.7	11.7
	James M. Martin	119.8	10.5
	M. B. Franklin	140.2	10.2
	Minero Shufflebarger Franklin	145.2	9.2
	Joel F. Parrish	165.2	11
	Elizabeth K. Parrish	165.2	11
	Unknown	172.2	9.3
	Unknown	199.2	7.5
Row # 3			
	Charles B. Clark	37.7	25.2
	Nannie C. Clark	42.7	24.3
	Lila D. Clark	47.2	23.5
	Archie P. Montgomery	52.7	23.3
Row # 4			
	Robert E. Clark	31.3	36.2
	Mary L. Clark	35	35.8
	Mary Ann Clark	39	35.5
	James R. Clark	43.8	34.7
	William L. Clark	48.7	34.3
	Parris J. Gilmore	51.7	33.6
	C .T. Gilmore	54.4	33.3
	Mrs. C. E. Gilmore	58.14	32.4

¹ Shelton and Linkous measured the distance of the center of the headstone from the south fence and the distance of the western edge of the headstone to the west fence in feet.

	Mr. C. E. Gilmore	62.7	31.8
ROW #5			
	Unknown	5	63
	Isaac Blankenship	9.6	61.9
	Unknown	14.6	60.7
	Unknown	22.6	58.8
	Unknown	44.6	53.6
	Unknown	49.6	52.4
	Malichi Shufflebarger	58.6	50.3
	Maggie Sue Shufflebarger	67.6	50
	ECF (?)	69.6	50
	Unknown	101.6	43.4
	Unknown	106.6	42.3
	F. S. Shelton	120.6	39.5
	Unknown	124.1	38.3
	Malinda H. Woods	131.1	36
	John G. Woods	131.1	36
ROW#6			
	Unknown	5.6	72.4
	Unknown	9.6	71.9
	Anderson Alley	34	68.5
	Martha Alley	38.1	68.5
	Unknown	42.7	67.3
	Maggie L. Dudley	50.3	66.3
	Sarah Elizabeth Akers	54.3	65.7
	Millard Filmore Akers	58.3	65.1
	Frances C. Norvell	66.3	64
	Martha Haymaker	124.8	49
	Willie C. Shelton	129.5	48
	Unknown	152	43.3
	Unknown	170.5	39.4
	Unknown	175	38.5
ROW # 7			
	Unknown	29.3	78

	Unknown	34.3	78
	Unknown	113.3	59
	Unknown	119.3	59
	Unknown	134.3	54.4
ROW # 8			
	Dow Jones	6.2	87
	Unknown	9.5	87
	Cephas Jones	28.8	86
	Mattie Wills	33.8	85.5
	Della Scott	38.8	85
	Unknown	48.8	84.4
	Unknown	34.8	70.8
	Col. Robert C. Trigg	139.8	70.4
	Unknown	162.8	68
	Martha F. Holman	167.8	66.8
ROW #9			
	Unknown	6.7	97
	Unknown	11.7	96.3
	James Brown	88	85.3
	Unknown	156	77.5
	Unknown	161	78
ROW # 10			
	Unknown	6.5	99.2
	Unknown	14	99.2
	Unknown	134.7	89.8
ROW # 11			
	Eliz Scott Taylor	109.7	97.3
	Flagg Family Headstone	122.7	97.8
	William C. Flagg	120.3	97.8
	Mary Sherwood Flagg	116.2	97.8
	James Robert Flagg	113.7	97.8
	Ellen Craig Flagg	124.7	97.8
	William J. Flagg	128.7	97.8
	Henry E. Flagg	130.7	97.8

	Infant Flagg	122.7	97.8
	Malinda Craig Taylor	163.1	94.6
ROW # 12			
	Matilda H. Jennings	38.4	116.7
	B. F. Jennings	42.4	116.4
	Luther A. Jennings	47.4	116
	Unknown	74.8	108.8
	Mary T. Craig	128.8	117
ROW # 13			
	Addell Watson	58	128.1
	Rev. Charles A. Miller	60.7	127.9
	Melinda Taylor Miller	65.7	127.6
	Mrs. Fannie Miller	70.5	128.2
	Unknown	113.2	126.5
	Matilda L. Miller	90	124.5
	Dr. Joseph Miller	94.4	125.1
	Lewis Miller	98.8	125.8
	James R. Craig	121.3	117.6
	John Craig, Jr.	127.3	117.1
	John Craig	131.7	118.5
	Emeline Craig	137.3	117.4
ROW #14			
	Ellen Craig Flagg	129.6	128.4
	Capt. James Craig	133.9	128.1
ROW # 15			
	Miss Janet Reid	178	138
	Peter W. Reid	182.5	137.7
ROW #16			
	Thomas W. Pettus	11	167.4
	Rebecca Pettus	15.3	167.1
	Sallie Meade Kyle	137	149.4
	William Emmett Kyle	142.7	149
	Amanda Montgomery Kyle	147.4	148.7
	Robert Gibboney Kyle	152.8	148.5

ROW #17			
	George E. Wade	99.2	172.4
	Mary E. Wade	100.7	172
	Unknown	103.2	171.5
	Benjamin D. Wade	105.2	171
	Hamilton D. Wade	108.2	170.4
	Charity Douglas	112.6	169.7
ROW # 18			
	Unknown	41.1	188.8
	Unknown	46	188.6
	James R. Flagg	53.4	188.4
	Mrs. M. J. Flagg	58.2	189
	Mrs. Sarah Murray	63.1	188.7
	Miss Sallie Murray	68.1	184.3
	Miss Jane Murray	84.2	183.2
	Unknown	104.3	177.9
	Unknown	110.1	177.8
	Hamilton Wade	115.1	177.3
	Unknown	120.1	177.1
	Kate Lester Craig Beasley	158.4	171.1
ROW # 19			
	Rebecca Wade	94.5	191.6
	James Wade	99.5	191.3
	Eliza F. Wade	103.7	191
	HNAN (?)	110.2	190.6
	William Wade	120.3	194
	Emily Wade	124.3	193.7
	Charles Lewis Craig	159.9	189.8
ROW #20			
	David Jones	25	212.8
	Margaret Jones	29.5	212.5
	Unknown	62	208.8
	Unknown	66.4	208.4
	Bettie Eskridge Shields	71.4	108.1

	Unknown	112.1	201
	Unknown	130.1	198.7
	Elizabeth Gray Craig	160.1	191.8
	John B. Craig	164.1	190.9
	Charles Joseph Craig	168.5	192.9
	Brainard W. Craig	172.5	187.9
	Annie Augusta Craig	176.7	189.1

Scattered Grave Marker Fragments Found in 1999

NAME	Feet from South Fence	Feet from West Fence
Doc. George Anderson	Near 115	Near 200
John Anderson	Near 115	Near 200
Mrs. Ella L. Wade	Near 115	Near 200
Capt. James Bratton	Near 115	Near 200

Graves Noted in 1950 Inventory, Missing in 1999

NAME	Feet from South Fence	Feet from West Fence
Anna Montgomery Craig	?	?
Sarah Leek Anderson	?	?
Paris Shufflebarger	?	?
Magdalene Shufflebarger	?	?
Robert Flagg	?	?
Mary J. Lee	?	?
Rebecca A. Lee	?	?
Elizabeth M. Bratton	?	?

Graves Noted in 1934 Inventory, Missing in 1999 and 1950

NAME	Feet from South Fence	Feet from West Fence
George A. Wade		
Mary Wade		